

# 2219 KETELSEN DR

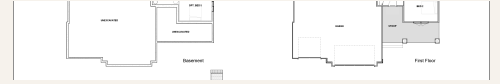

\$925,000

 2219 KETELSEN DR,  
AMES, IA 50010

 4 BEDROOMS

 3 FULL, 1 HALF  
BATHROOMS

 0.27 ACRES

1,422 LOWER SF |

1,932 MAIN SF |

 3,354 TOTAL SF  
LIVING AREA

Discover refined living in this beautifully crafted home by Caliber Homes located in the prestigious Quarry Estates neighborhood and the highly sought-after Gilbert School District. Boasting nearly 3,400 finished square feet, this 4-bedroom, 3.5-bath residence combines upscale finishes with versatile living spaces designed for modern lifestyles. The home's stunning brick exterior creates an inviting and distinctive curb appeal. Inside, you'll find premium features such as quartz countertops, custom cabinetry, intricate trim details, and stylish fixtures that elevate every room. The chef's kitchen includes a spacious walk-in pantry and flows effortlessly into the open-concept living and dining areas—perfect for entertaining or everyday living. The luxurious primary suite offers a relaxing retreat with complete with an elegant tiled shower, custom double vanity and an expansive walk-in closet. Three additional bedrooms provide comfort and space for family or guests, with the option to finish a fifth bedroom to suit your needs. A conveniently...



 mapbox

© Mapbox © OpenStreetMap [Improve this map](#)